



Connah's Quay Low Carbon Power

Traffic Regulation Measures Plans

Planning Inspectorate Reference: EN010166

Document Reference: EN010166/APP/2.7

Planning Act 2008 (as amended)

Infrastructure Planning (Applications: Prescribed Forms and Procedure) Regulations

2009 - Regulation 5(2)(o)

Revision 01

March 2026



PROJECT
 Connah's Quay Low
 Carbon Power

CONSULTANT

AECOM Limited
 The Colmore Building
 Colmore Circus, Queensway
 Birmingham, B4 6AT
 www.aecom.com

- GENERAL NOTES**
1. ALL DIMENSIONS IN METRES UNLESS STATED OTHERWISE.
 2. DO NOT SCALE FROM THIS DRAWING USE ONLY PRINTED DIMENSIONS.
 3. THESE PLANS SHOULD BE READ IN CONJUNCTION WITH SCHEDULE 8 OF THE DEVELOPMENT CONSENT ORDER.

KEY
 ORDER LIMITS

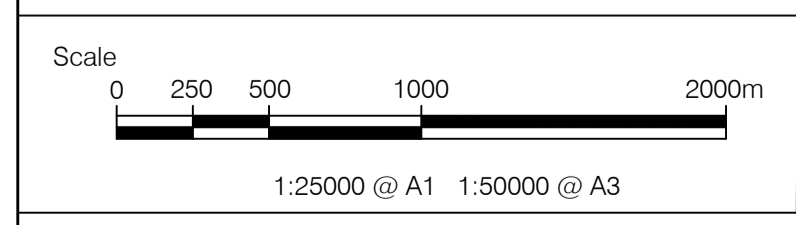

ISSUE/REVISION		
NO	DATE	DESCRIPTION
01	06/02/2026	ORDER LIMITS UPDATE
00	10/07/2025	DCO APPLICATION
I/R	DATE	DESCRIPTION

ISSUE PURPOSE
 DCO APPLICATION
DATE
 March 2026

PROJECT NUMBER
 60768754

LEGISLATION REFERENCE
 APFP 2009 Regulation 5(2)(o)

SHEET TITLE
 Traffic Regulation Measures
 Key Plan

DOCUMENT REFERENCE NUMBER
 EN10166/APP/2.7

This drawing has been prepared for the use of AECOM's client. It may not be used, modified, reproduced or relied upon by third parties, except as agreed by AECOM or as required by law. AECOM accepts no responsibility, and denies any liability whatsoever, to any party that uses or relies on this drawing without AECOM's express written consent. Do not scale this document.

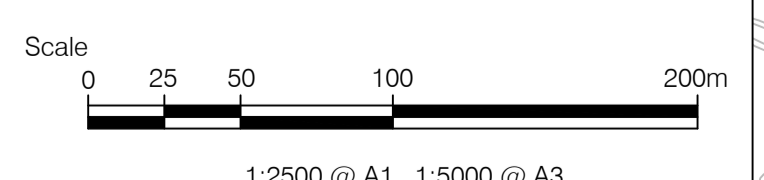

SHEET 1
 SHEET 2 ↓

PROJECT
 Connah's Quay Low
 Carbon Power

CONSULTANT
 AECOM Limited
 The Colmore Building
 Colmore Circus, Queensway
 Birmingham, B4 6AT
 www.aecom.com

- GENERAL NOTES**
1. ALL DIMENSIONS IN METRES UNLESS STATED OTHERWISE.
 2. DO NOT SCALE FROM THIS DRAWING USE ONLY PRINTED DIMENSIONS.
 3. THESE PLANS SHOULD BE READ IN CONJUNCTION WITH SCHEDULE 8 OF THE DEVELOPMENT CONSENT ORDER.

KEY

	ORDER LIMITS
	TRAFFIC REGULATION MEASURES IDENTIFIER
	TRAFFIC REGULATION MEASURES

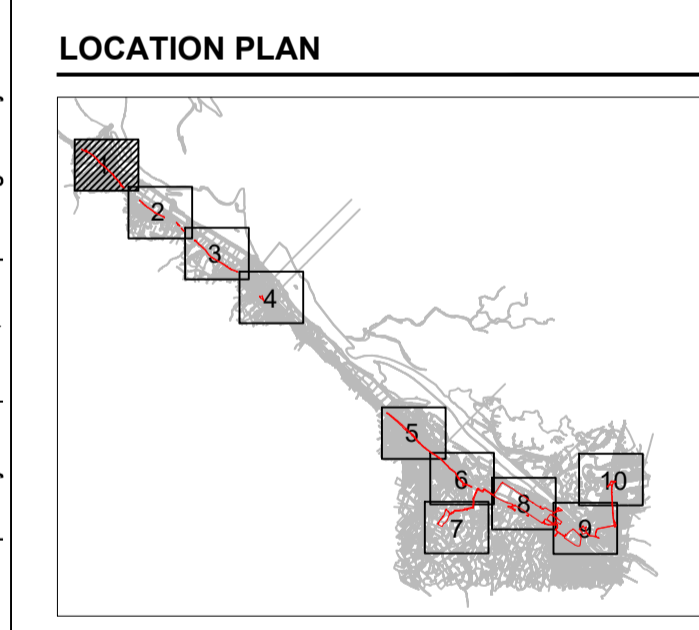

ISSUE/REVISION

NO	DATE	DESCRIPTION
01	06/02/2026	ORDER LIMITS UPDATE
00	10/07/2025	DCO APPLICATION
1/R		

ISSUE PURPOSE
 DCO APPLICATION

DATE
 March 2026

PROJECT NUMBER
 60768754

LEGISLATION REFERENCE
 APFP 2009 Regulation 5(2)(o)

SHEET TITLE
 Traffic Regulation Measures
 Sheet 1 of 10

DOCUMENT REFERENCE NUMBER
 EN10166/APP/2.7



PROJECT
 Connah's Quay Low
 Carbon Power

CONSULTANT
 AECOM Limited
 The Colmore Building
 Colmore Circus, Queensway
 Birmingham, B4 6AT
 www.aecom.com

- GENERAL NOTES**
1. ALL DIMENSIONS IN METRES UNLESS STATED OTHERWISE.
 2. DO NOT SCALE FROM THIS DRAWING USE ONLY PRINTED DIMENSIONS.
 3. THESE PLANS SHOULD BE READ IN CONJUNCTION WITH SCHEDULE 8 OF THE DEVELOPMENT CONSENT ORDER.

KEY

	ORDER LIMITS
	TRAFFIC REGULATION MEASURES IDENTIFIER
	TRAFFIC REGULATION MEASURES

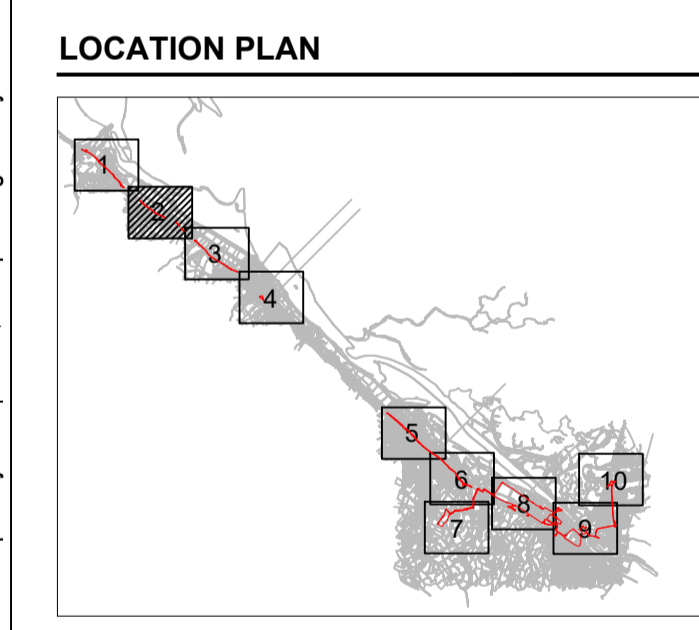

ISSUE/REVISION

NO	DATE	DESCRIPTION
01	06/02/2026	ORDER LIMITS UPDATE
00	10/07/2025	DCO APPLICATION

ISSUE PURPOSE
 DCO APPLICATION

DATE
 March 2026

PROJECT NUMBER
 60768754

LEGISLATION REFERENCE
 APFP 2009 Regulation 5(2)(o)

SHEET TITLE
 Traffic Regulation Measures
 Sheet 2 of 10

DOCUMENT REFERENCE NUMBER
 EN10166/APP/2.7



PROJECT
 Connah's Quay Low
 Carbon Power

CONSULTANT
 AECOM Limited
 The Colmore Building
 Colmore Circus, Queensway
 Birmingham, B4 6AT
 www.aecom.com

- GENERAL NOTES**
1. ALL DIMENSIONS IN METRES UNLESS STATED OTHERWISE.
 2. DO NOT SCALE FROM THIS DRAWING USE ONLY PRINTED DIMENSIONS.
 3. THESE PLANS SHOULD BE READ IN CONJUNCTION WITH SCHEDULE 8 OF THE DEVELOPMENT CONSENT ORDER.

KEY

	ORDER LIMITS
	TRAFFIC REGULATION MEASURES IDENTIFIER
	TRAFFIC REGULATION MEASURES

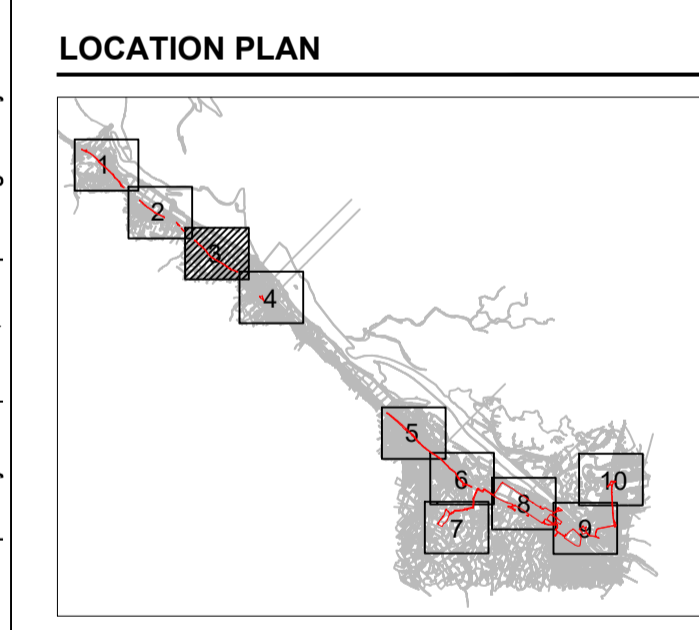

ISSUE/REVISION

IR	DATE	DESCRIPTION
01	06/02/2026	ORDER LIMITS UPDATE
00	10/07/2025	DCO APPLICATION

ISSUE PURPOSE
 DCO APPLICATION

DATE
 March 2026

PROJECT NUMBER
 60768754

LEGISLATION REFERENCE
 APFP 2009 Regulation 5(2)(o)

SHEET TITLE
 Traffic Regulation Measures
 Sheet 3 of 10

DOCUMENT REFERENCE NUMBER
 EN10166/APP/2.7

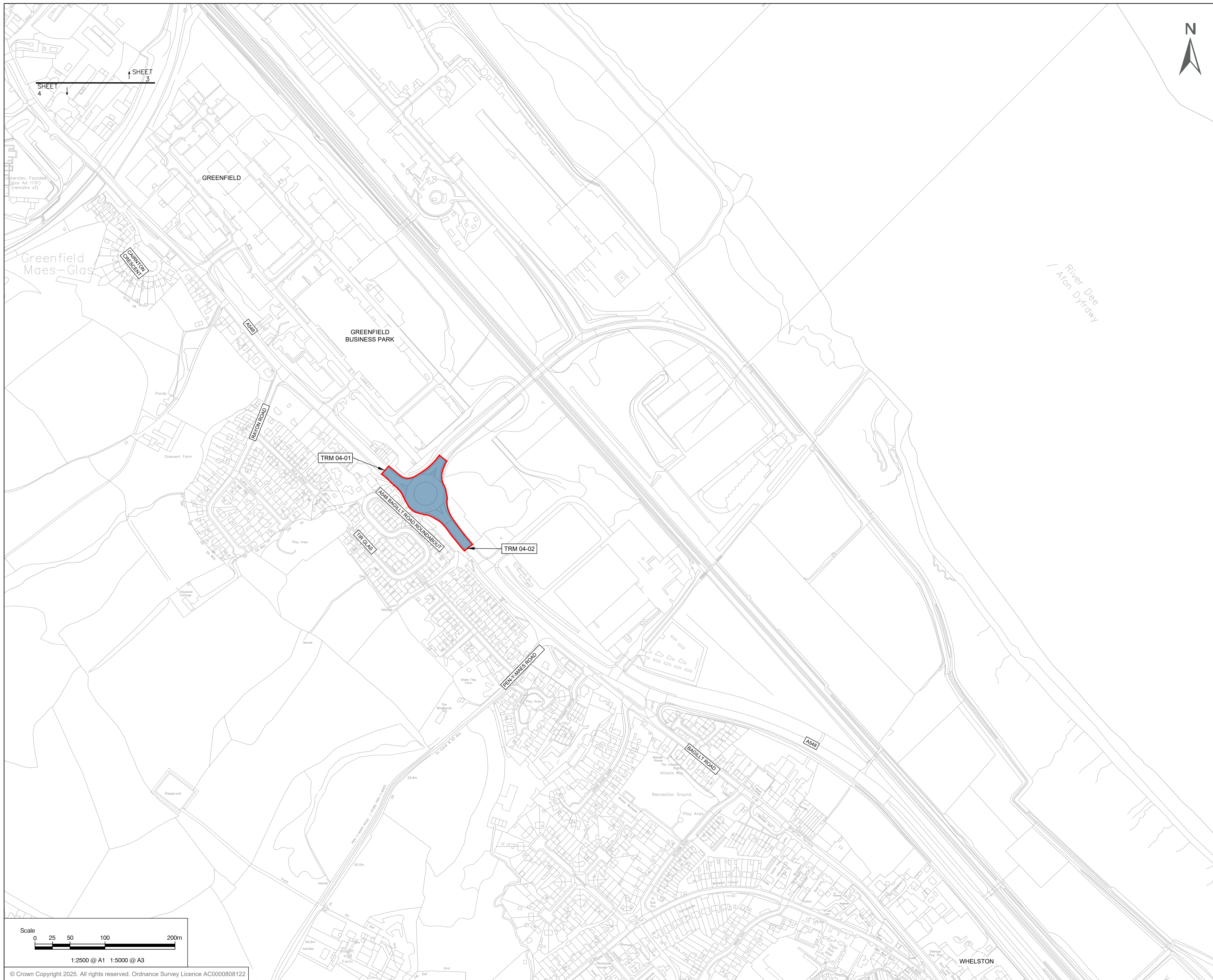

PROJECT
 Connah's Quay Low
 Carbon Power

CONSULTANT
 AECOM Limited
 The Colmore Building
 Colmore Circus, Queensway
 Birmingham, B4 6AT
 www.aecom.com

- GENERAL NOTES**
1. ALL DIMENSIONS IN METRES UNLESS STATED OTHERWISE.
 2. DO NOT SCALE FROM THIS DRAWING USE ONLY PRINTED DIMENSIONS.
 3. THESE PLANS SHOULD BE READ IN CONJUNCTION WITH SCHEDULE 8 OF THE DEVELOPMENT CONSENT ORDER.

KEY

	ORDER LIMITS
	TRAFFIC REGULATION MEASURES IDENTIFIER
	TRAFFIC REGULATION MEASURES

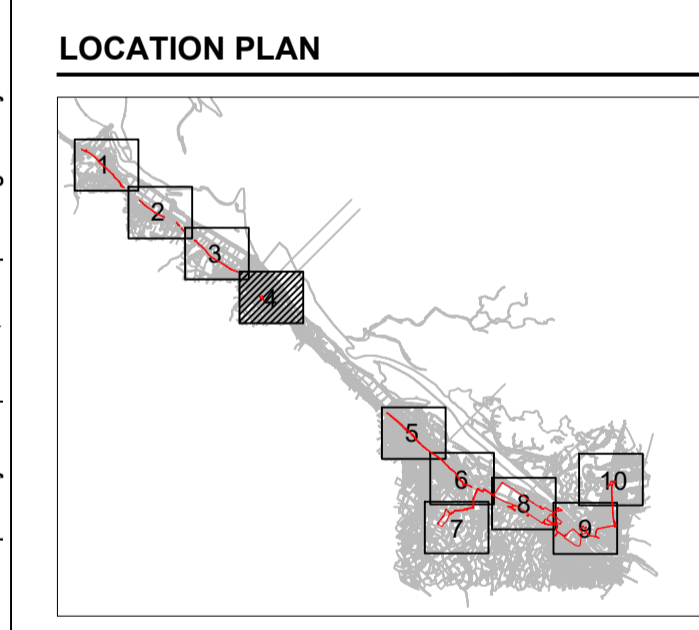

ISSUE/REVISION

NO	DATE	DESCRIPTION
01	06/02/2026	ORDER LIMITS UPDATE
00	10/07/2025	DCO APPLICATION

ISSUE PURPOSE
 DCO APPLICATION

DATE
 March 2026

PROJECT NUMBER
 60768754

LEGISLATION REFERENCE
 APFP 2009 Regulation 5(2)(o)

SHEET TITLE
 Traffic Regulation Measures
 Sheet 4 of 10

DOCUMENT REFERENCE NUMBER
 EN10166/APP/2.7

This drawing has been prepared for the use of AECOM's client. It may not be used, modified, reproduced or relied upon by third parties, except as agreed by AECOM or as required by law. AECOM accepts no responsibility, and denies any liability whatsoever, to any party that uses or relies on this drawing without AECOM's express written consent. Do not scale this document.

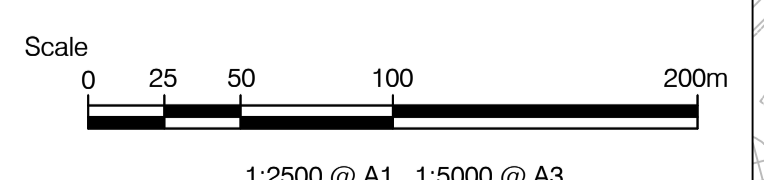

FOR CONTINUATION OF TRAFFIC REGULATION PROVISION AREA PLEASE REFER TO SHEET 6

PROJECT
 Connah's Quay Low
 Carbon Power

CONSULTANT
 AECOM Limited
 The Colmore Building
 Colmore Circus, Queensway
 Birmingham, B4 6AT
 www.aecom.com

- GENERAL NOTES**
1. ALL DIMENSIONS IN METRES UNLESS STATED OTHERWISE.
 2. DO NOT SCALE FROM THIS DRAWING USE ONLY PRINTED DIMENSIONS.
 3. THESE PLANS SHOULD BE READ IN CONJUNCTION WITH SCHEDULE 8 OF THE DEVELOPMENT CONSENT ORDER.

KEY

	ORDER LIMITS
	TRAFFIC REGULATION MEASURES IDENTIFIER
	TRAFFIC REGULATION MEASURES

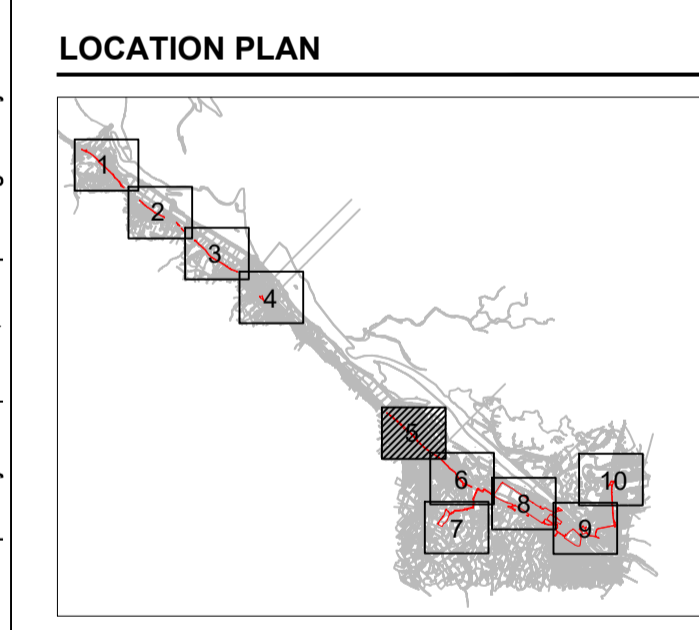

ISSUE/REVISION

NO	DATE	DESCRIPTION
01	06/02/2026	ORDER LIMITS UPDATE
00	10/07/2025	DCO APPLICATION
1/R	DATE	DESCRIPTION

ISSUE PURPOSE
 DCO APPLICATION

DATE
 March 2026

PROJECT NUMBER
 60768754

LEGISLATION REFERENCE
 APFP 2009 Regulation 5(2)(o)

SHEET TITLE
 Traffic Regulation Measures
 Sheet 5 of 10

DOCUMENT REFERENCE NUMBER
 EN10166/APP/2.7

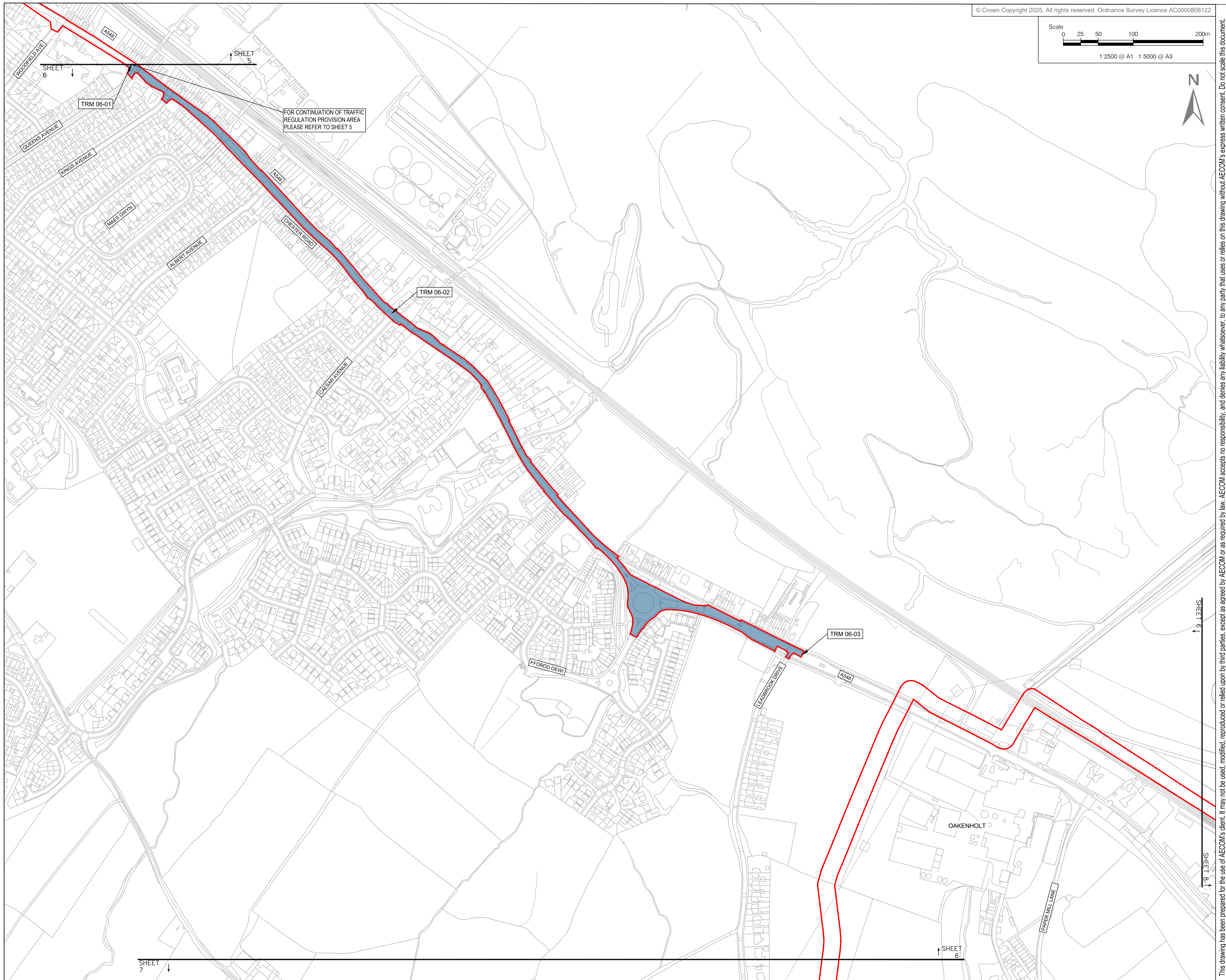

© Crown Copyright 2025. All rights reserved. Ordnance Survey Licence AC0000808122

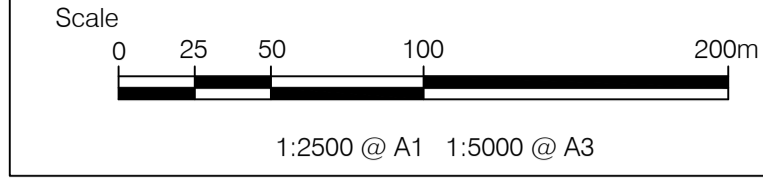

PROJECT
 Connah's Quay Low
 Carbon Power

CONSULTANT
 AECOM Limited
 The Colmore Building
 Colmore Circus, Queensway
 Birmingham, B4 6AT
 www.aecom.com

- GENERAL NOTES**
1. ALL DIMENSIONS IN METRES UNLESS STATED OTHERWISE.
 2. DO NOT SCALE FROM THIS DRAWING USE ONLY PRINTED DIMENSIONS.
 3. THESE PLANS SHOULD BE READ IN CONJUNCTION WITH SCHEDULE 8 OF THE DEVELOPMENT CONSENT ORDER.

KEY

	ORDER LIMITS
	TRAFFIC REGULATION MEASURES IDENTIFIER
	TRAFFIC REGULATION MEASURES

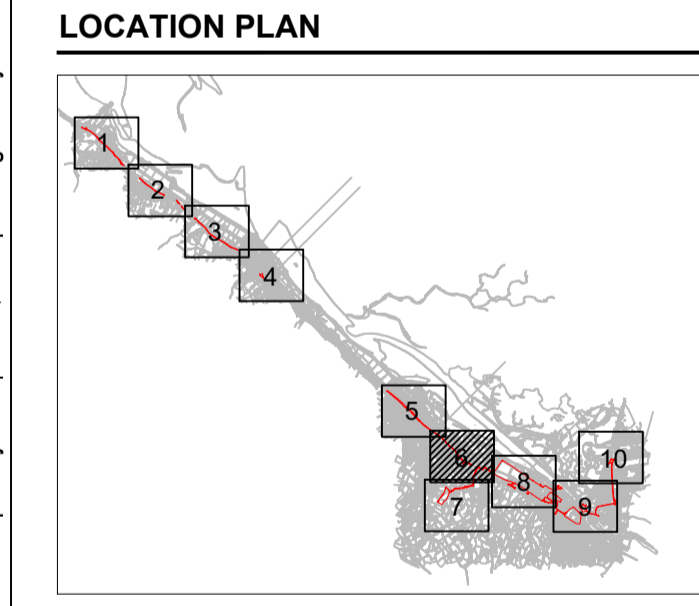

ISSUE/REVISION

IR	DATE	DESCRIPTION
01	06/02/2026	ORDER LIMITS UPDATE
00	10/07/2025	DCO APPLICATION

ISSUE PURPOSE
 DCO APPLICATION

DATE
 March 2026

PROJECT NUMBER
 60768754

LEGISLATION REFERENCE
 APFP 2009 Regulation 5(2)(o)

SHEET TITLE
 Traffic Regulation Measures
 Sheet 6 of 10

DOCUMENT REFERENCE NUMBER
 EN10166/APP/2.7

This drawing has been prepared for the use of AECOM's client. It may not be used, modified, reproduced or relied upon by third parties, except as agreed by AECOM or as required by law. AECOM accepts no responsibility, and denies any liability whatsoever, to any party that uses or relies on this drawing without AECOM's express written consent. Do not scale this document.

SHEET 7

SHEET 6

SHEET 6

SHEET 8

FOR CONTINUATION OF TRAFFIC REGULATION PROVISION AREA PLEASE REFER TO SHEET 5

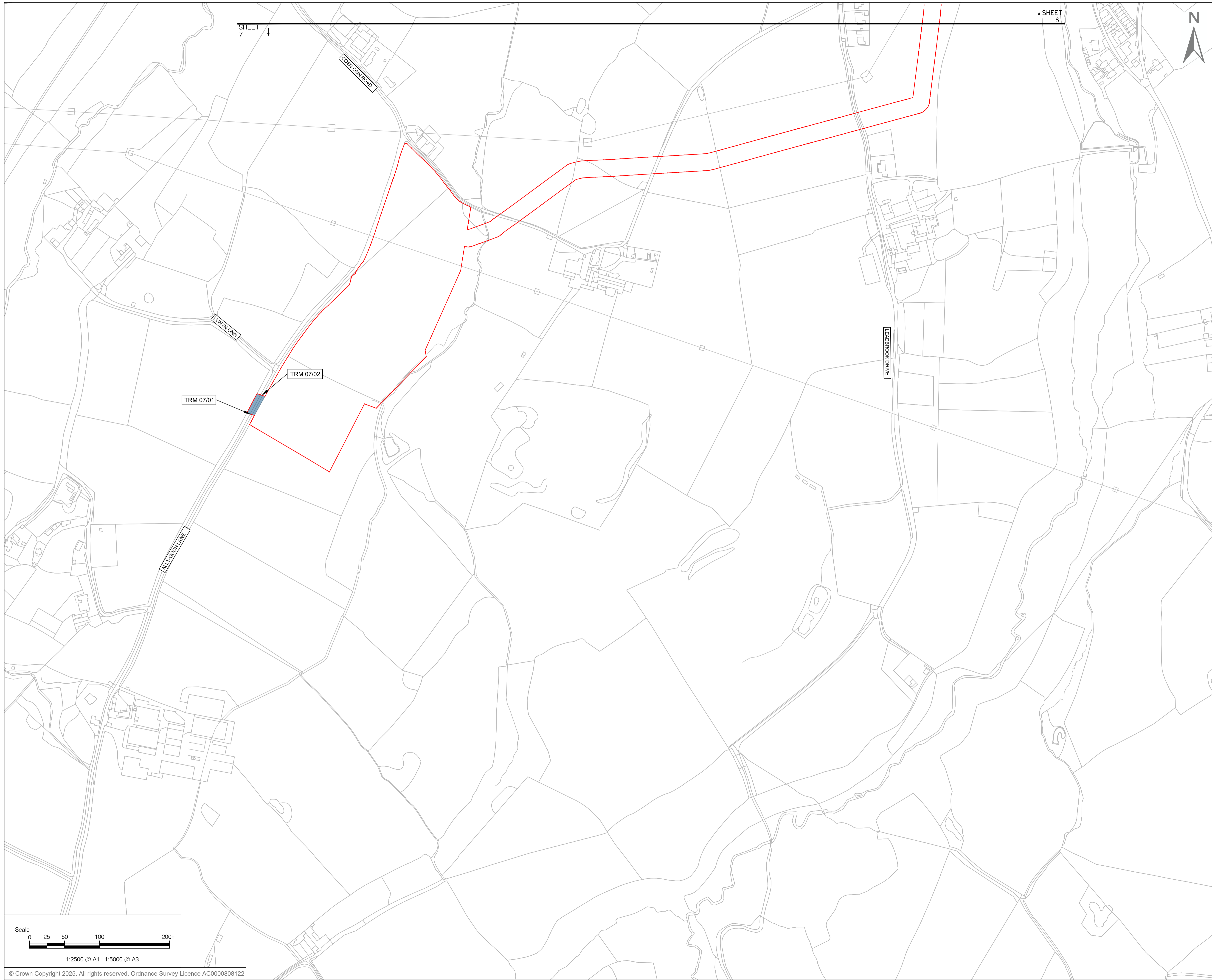

SHEET 7

SHEET 6



PROJECT
 Connah's Quay Low
 Carbon Power

CONSULTANT
 AECOM Limited
 The Colmore Building
 Colmore Circus, Queensway
 Birmingham, B4 6AT
 www.aecom.com

- GENERAL NOTES**
- ALL DIMENSIONS IN METRES UNLESS STATED OTHERWISE.
 - DO NOT SCALE FROM THIS DRAWING USE ONLY PRINTED DIMENSIONS.
 - THESE PLANS SHOULD BE READ IN CONJUNCTION WITH SCHEDULE 8 OF THE DEVELOPMENT CONSENT ORDER.

KEY

	ORDER LIMITS
	TRAFFIC REGULATION MEASURES IDENTIFIER
	TRAFFIC REGULATION MEASURES

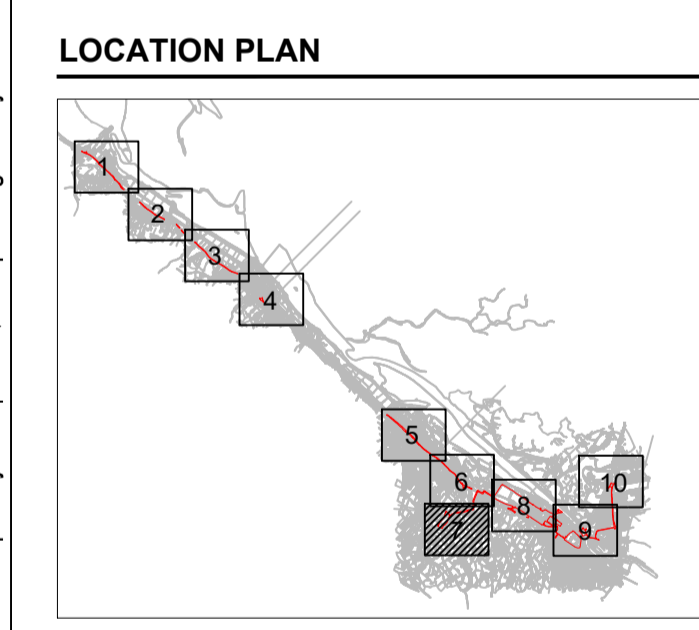

ISSUE/REVISION

NO	DATE	DESCRIPTION
01	06/02/2026	ORDER LIMITS UPDATE
00	10/07/2025	DCO APPLICATION
I/R	DATE	DESCRIPTION

ISSUE PURPOSE
 DCO APPLICATION

DATE
 March 2026

PROJECT NUMBER
 60768754

LEGISLATION REFERENCE
 APFP 2009 Regulation 5(2)(o)

SHEET TITLE
 Traffic Regulation Measures
 Sheet 7 of 10

DOCUMENT REFERENCE NUMBER
 EN10166/APP/2.7

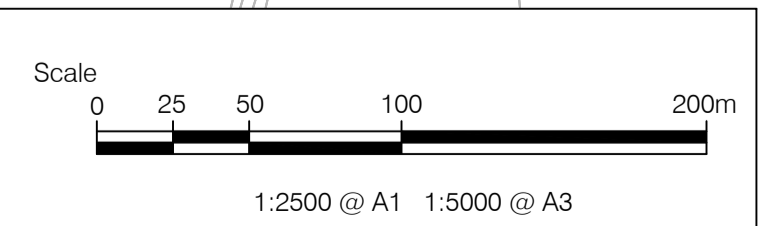

This drawing has been prepared for the use of AECOM's client. It may not be used, modified, reproduced or relied upon by third parties, except as agreed by AECOM or as required by law. AECOM accepts no responsibility, and denies any liability whatsoever, to any party that uses or relies on this drawing without AECOM's express written consent. Do not scale this document.

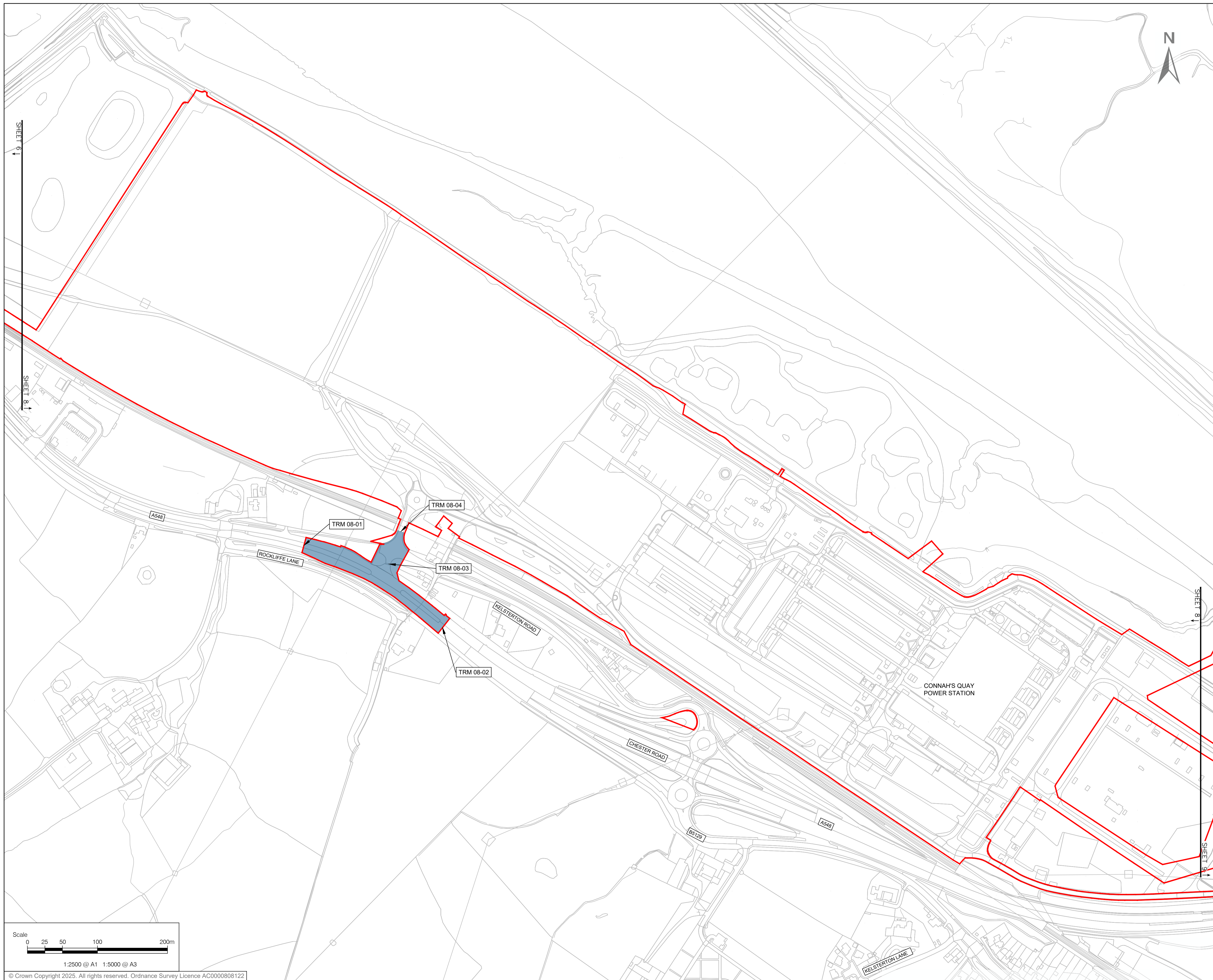

PROJECT
 Connah's Quay Low
 Carbon Power

CONSULTANT
 AECOM Limited
 The Colmore Building
 Colmore Circus, Queensway
 Birmingham, B4 6AT
 www.aecom.com

- GENERAL NOTES**
1. ALL DIMENSIONS IN METRES UNLESS STATED OTHERWISE.
 2. DO NOT SCALE FROM THIS DRAWING USE ONLY PRINTED DIMENSIONS.
 3. THESE PLANS SHOULD BE READ IN CONJUNCTION WITH SCHEDULE 8 OF THE DEVELOPMENT CONSENT ORDER.

KEY

	ORDER LIMITS
	TRAFFIC REGULATION MEASURES IDENTIFIER
	TRAFFIC REGULATION MEASURES

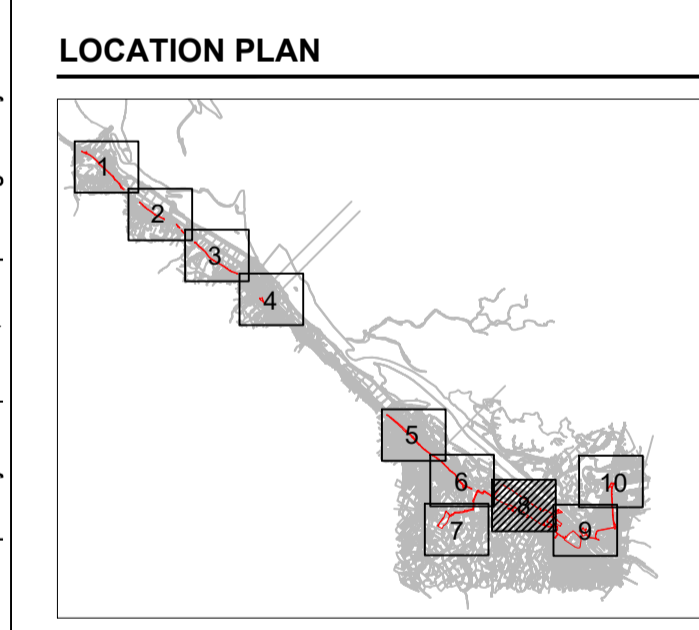

ISSUE/REVISION

NO	DATE	DESCRIPTION
01	06/02/2026	ORDER LIMITS UPDATE
00	10/07/2025	DCO APPLICATION

ISSUE PURPOSE
 DCO APPLICATION

DATE
 March 2026

PROJECT NUMBER
 60768754

LEGISLATION REFERENCE
 APFP 2009 Regulation 5(2)(o)

SHEET TITLE
 Traffic Regulation Measures
 Sheet 8 of 10

DOCUMENT REFERENCE NUMBER
 EN10166/APP/2.7

This drawing has been prepared for the use of AECOM's client. It may not be used, modified, reproduced or relied upon by third parties, except as agreed by AECOM or as required by law. AECOM accepts no responsibility, and denies any liability whatsoever, to any party that uses or relies on this drawing without AECOM's express written consent. Do not scale this document.

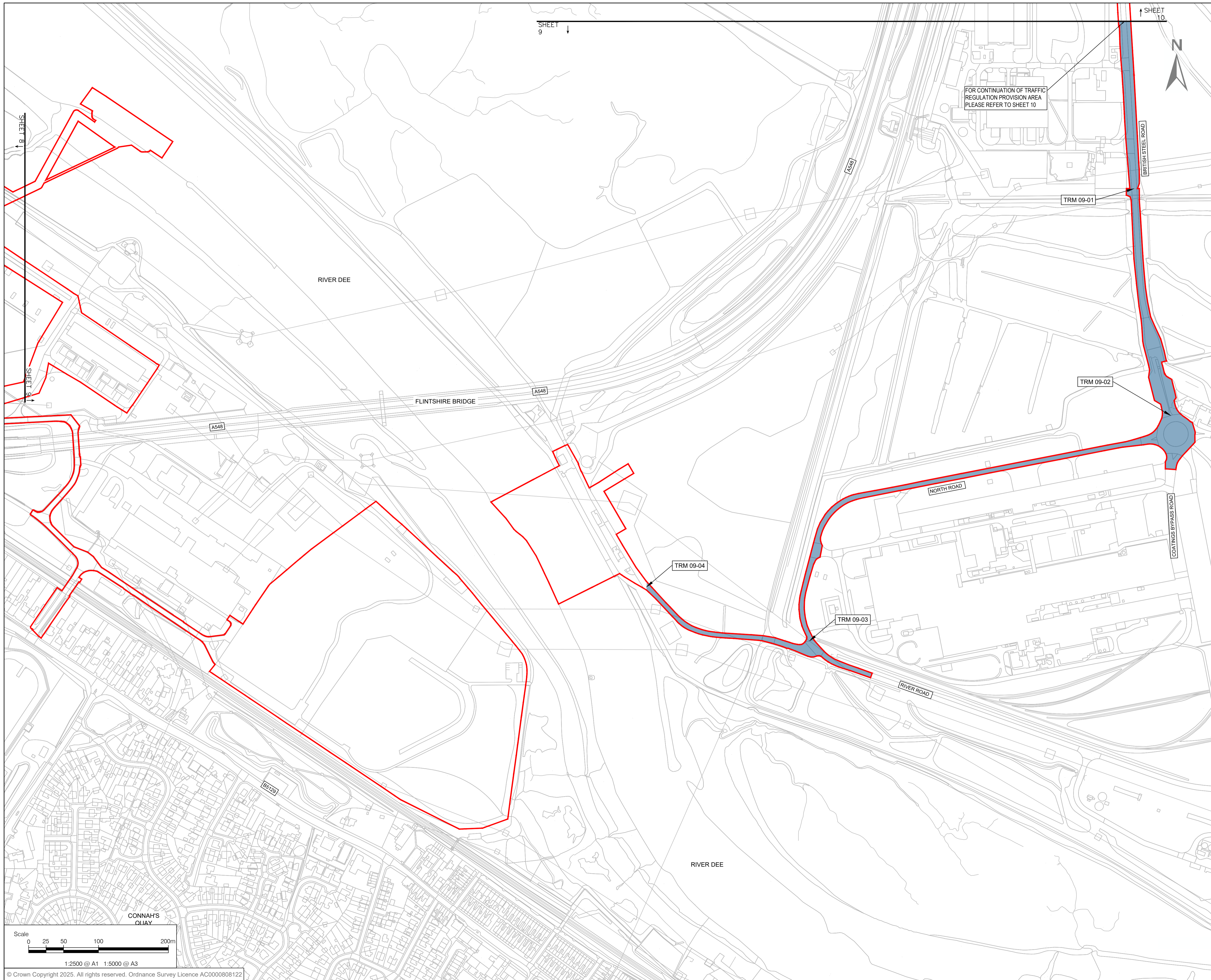

FOR CONTINUATION OF TRAFFIC REGULATION PROVISION AREA PLEASE REFER TO SHEET 10

PROJECT
 Connah's Quay Low Carbon Power

CONSULTANT
 AECOM Limited
 The Colmore Building
 Colmore Circus, Queensway
 Birmingham, B4 6AT
 www.aecom.com

GENERAL NOTES

1. ALL DIMENSIONS IN METRES UNLESS STATED OTHERWISE.
2. DO NOT SCALE FROM THIS DRAWING USE ONLY PRINTED DIMENSIONS.
3. THESE PLANS SHOULD BE READ IN CONJUNCTION WITH SCHEDULE 8 OF THE DEVELOPMENT CONSENT ORDER.

KEY

- ORDER LIMITS
- TRAFFIC REGULATION MEASURES IDENTIFIER
- TRAFFIC REGULATION MEASURES

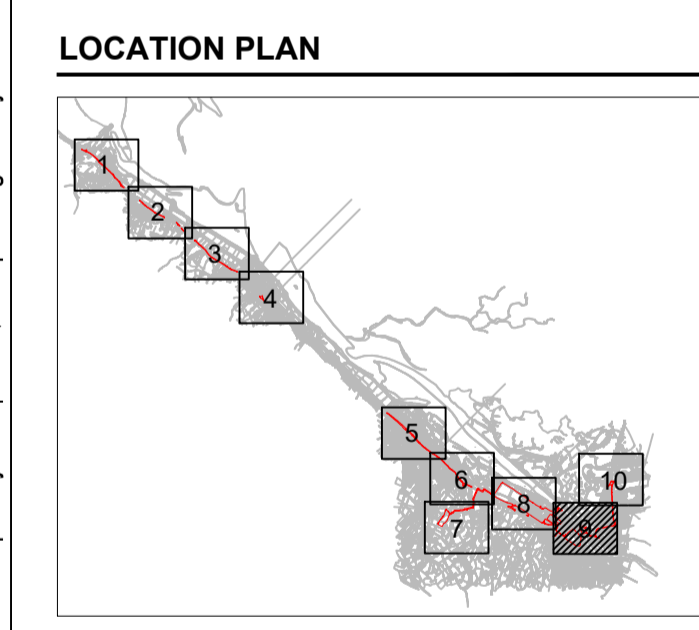

ISSUE/REVISION

NO	DATE	DESCRIPTION
01	06/02/2026	ORDER LIMITS UPDATE
00	10/07/2025	DCO APPLICATION

ISSUE PURPOSE
 DCO APPLICATION

DATE
 March 2026

PROJECT NUMBER
 60768754

LEGISLATION REFERENCE
 APFP 2009 Regulation 5(2)(o)

SHEET TITLE
 Traffic Regulation Measures
 Sheet 9 of 10

DOCUMENT REFERENCE NUMBER
 EN10166/APP/2.7

This drawing has been prepared for the use of AECOM's client. It may not be used, modified, reproduced or relied upon by third parties, except as agreed by AECOM or as required by law. AECOM accepts no responsibility, and denies any liability whatsoever, to any party that uses or relies on this drawing without AECOM's express written consent. Do not scale this document.

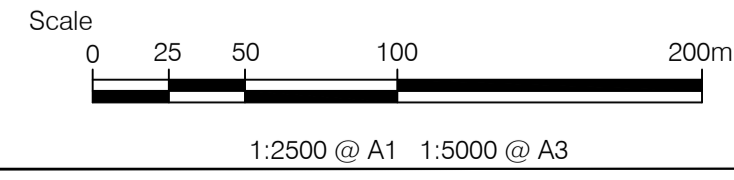

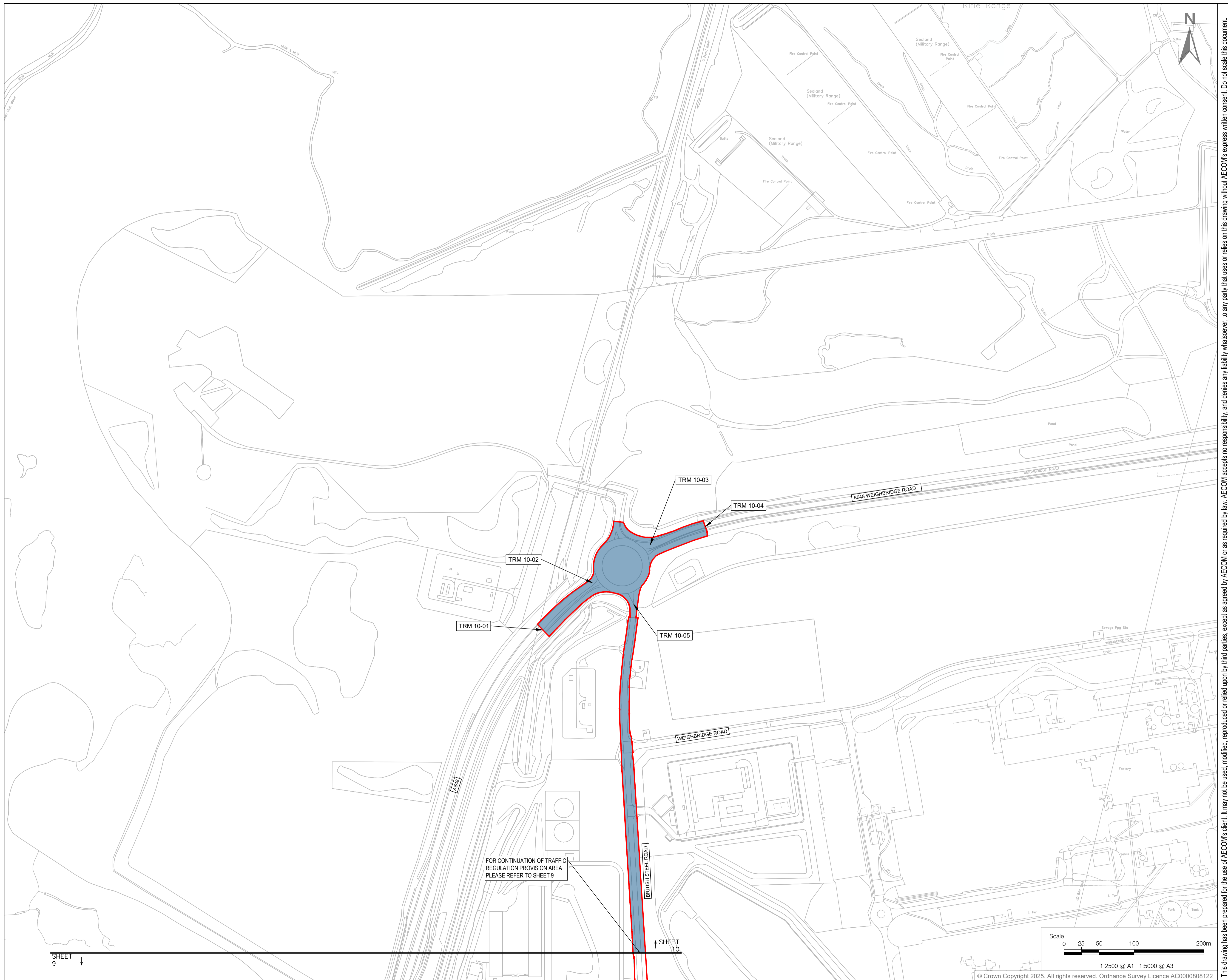

FOR CONTINUATION OF TRAFFIC
REGULATION PROVISION AREA
PLEASE REFER TO SHEET 9

↑ SHEET 10

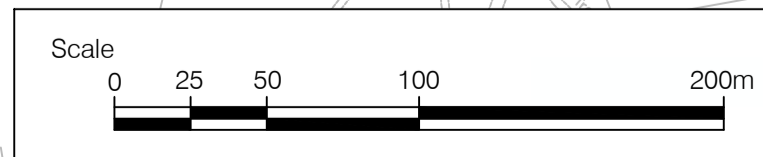

- GENERAL NOTES**
- ALL DIMENSIONS IN METRES UNLESS STATED OTHERWISE.
 - DO NOT SCALE FROM THIS DRAWING USE ONLY PRINTED DIMENSIONS.
 - THESE PLANS SHOULD BE READ IN CONJUNCTION WITH SCHEDULE 8 OF THE DEVELOPMENT CONSENT ORDER.

KEY

	ORDER LIMITS
	TRAFFIC REGULATION MEASURES IDENTIFIER
	TRAFFIC REGULATION MEASURES

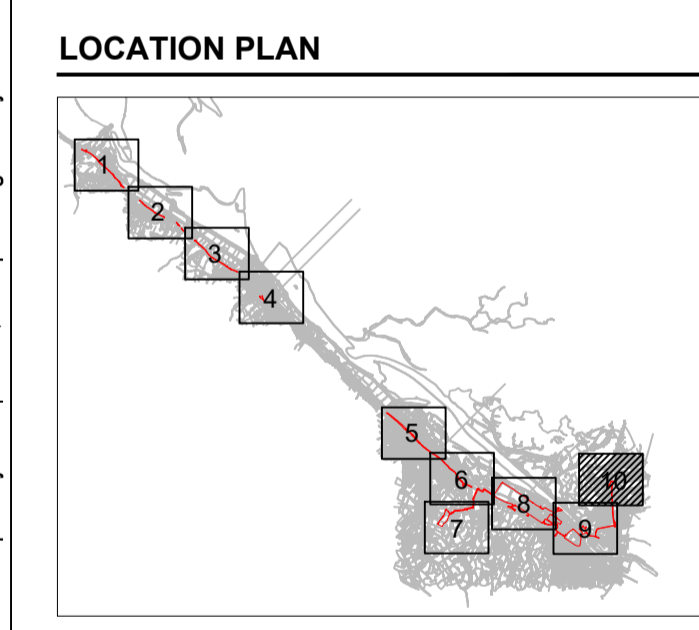

ISSUE/REVISION

NO	DATE	DESCRIPTION
01	06/02/2026	ORDER LIMITS UPDATE
00	10/07/2025	DCO APPLICATION
1/R		

ISSUE PURPOSE

DCO APPLICATION

DATE
March 2026

PROJECT NUMBER
60768754

LEGISLATION REFERENCE
APFP 2009 Regulation 5(2)(o)

SHEET TITLE
Traffic Regulation Measures
Sheet 10 of 10

DOCUMENT REFERENCE NUMBER
EN10166/APP/2.7

This drawing has been prepared for the use of AECOM's client. It may not be used, modified, reproduced or relied upon by third parties, except as agreed by AECOM or as required by law. AECOM accepts no responsibility, and denies any liability whatsoever, to any party that uses or relies on this drawing without AECOM's express written consent. Do not scale this document.